



# User manual



# BATfan 2 NEO



**US** Read this manual carefully, before the first use



## MANUFACTURER

**LEADER S.A.S.**  
Z.I. des Hautes-Vallées  
Chemin n° 34  
CS20014  
76930 Octeville sur Mer  
France



[www.leader-group.eu](http://www.leader-group.eu)

[www.tempest.us.com](http://www.tempest.us.com)

Our policy is to constantly seek to improve our products. We therefore reserve the right to change their technical specifications at any time and without prior notice - Non contractual images



PLEASE RECYCLE

Package leaflet code:  
BATfan2 NEO.00.ZN3.77.US.1

## 11 IDENTIFICATION



## 12 TROUBLESHOOTING

Problem	What to do
The fan does not work on battery power	<ul style="list-style-type: none"> <li>• Check the condition of the battery's 15A fuse.</li> <li>• Check that the battery is charged (control panel LED status).</li> <li>• See LED status description (P15/16).</li> </ul>
The fan does not work on AC power supply	<ul style="list-style-type: none"> <li>• Check the condition of the fuses (8A) for the 110V or (4A) for the 230V version.</li> <li>• Check that there is a good power supply.</li> <li>• See LED status description (P15/16).</li> </ul>
The battery will not charge	<ul style="list-style-type: none"> <li>• Check the condition of the fuses (15A and 8A) for the 110V or (15A and 4A) for the 230V version.</li> <li>• Check that there is a good power supply.</li> <li>• Check that the room temperature is between 32°F and 95°F 0 and 35°C.</li> <li>• Ensure that charging is not taking place immediately after a discharge.</li> <li>• See LED status description (P15/16).</li> </ul>
The fan has no battery life	<ul style="list-style-type: none"> <li>• Check that the battery is charged (control panel LED status).</li> <li>• Charge for the recommended time.</li> <li>• If battery is low, use AC power supply.</li> <li>• See LED status description (P15/16).</li> </ul>

## 13 SPARE PARTS

To identify your **BATFan 2 NEO** parts, please contact us.  
[info@groupe-leader.fr](mailto:info@groupe-leader.fr)

# Contents

1	INTRODUCTION .....	4
2	SAFETY INSTRUCTIONS .....	4
3	PRECAUTIONS .....	5
4	GENERAL FEATURES .....	6
5	PRESENTATION .....	7
6	COMMISSIONING INSTRUCTIONS .....	8
7	SETUP .....	8
8	USE .....	10
9	BATTERY .....	13
10	DESCRIPTION OF LED STATUS WHEN OPERATING .....	16
11	IDENTIFICATION .....	18
12	TROUBLESHOOTING .....	18
13	SPARE PARTS .....	18
14	WARRANTY .....	19

## 10 Description of LED status when operating

⇒ Battery level LED status during AC power supply use (battery charging):

Battery	0 to 20%	20 to 40%	40 to 60%	60 to 80%	80 to 100%

⇒ Battery level LED status during battery use:

Speed setpoint	Fan stopped	Speed 20%	Speed 40%	Speed 60%	Speed 80%	Speed 100%

⇒ Battery life with full battery:

Speed	40%	60%	80%	100%
Batfan Neo 20	3 hours	1 hour 30 minutes	35 minutes	20 minutes
Batfan Neo 45	6 hours 45 minutes	3 hours 20 minutes	1 hour 20 minutes	45 minutes

⇒ Speed setpoint LED status during battery and AC power supply use:

Battery	0 to 20%	20 to 40%	40 to 60%	60 to 80%	80 to 100%

Note 1: Pressing the button will increase the LED speed setpoint.  
Pressing the button will decrease the LED speed setpoint.

\*Note 2: LEDs indicate the selected speed setpoint; you must wait a few seconds to reach the desired speed.

## 3 PRECAUTIONS



- Before use: Visually inspect the **BATfan 2 NEO** and its accessories to check there is no damage.
  - If there is an unusual noise or the impeller gets jammed, stop immediately and inform **LEADER**.
  - The instructions for use and safety guidelines must be followed in order to prevent any accident. Any disassembly or repair must be performed by **LEADER** or an approved operator.
  - This device has a **NIMH** (Nickel Metal Hydride) battery, and therefore it does not need to be discharged before recharging.
- NB: BATfan 2 NEO** uses a NiMH battery; it is therefore not subject to specific regulations regarding air transport.
- Ensure that the Batfan is charged in an environment with a temperature between **32°F and 95°F max** (0°C et +35°C max).
  - **NB: The BATfan 2 NEO** battery will not charge at temperatures below **32°F** (0°C).
  - To maintain battery performance and offset the natural self-discharge, Batfan 2 must be recharged at least every **6 weeks**.
  - It must be stored with a charged battery between **46.4°F and 95°F** (+8°C à +35°C).
  - Use between **-4°F and 104°F** (-20°C à +40°C) on AC power supply.  
**-4°F to 104°F** (-20°C à +40°C) on battery power (whilst respecting storage temperatures).
- NB:** Ensure that each person responsible for the device/using this device has read the user instructions and safety guidelines relating to a rotating machine.

**Warning:** before using a battery that has been stored for a long period, it is advisable to run several charge and discharge cycles to recover its initial performance. If the battery is stored for over a year, a maintenance charge should be made once every 6 months to compensate for self-discharge, and prevent leaks and deterioration.

- Avoid storing in electrostatically charged areas.
- Do not store together with electro-conductive material.

### 2/Battery Treatment

Discarding batteries directly in the garbage greatly harms the environment. By replacing your batteries from **LEADER** or an authorised distributor, you can be certain they will be recycled according to environmental rules.

Do not throw batteries away just anywhere; limit any risk of pollution and avoid contaminating nature with the traces of heavy metals still contained in certain types of batteries.

Batteries are collected and reprocessed; they contain certain recoverable heavy metals. Deposit them in designated areas (recycling centres, collection points...)

### 3/Features

- **BATfan 2 NEO Battery 20 minutes**

Reference: 2008800

Type: 39S2P VH A, NIMH (nickel-metal hydride). Assembled with heatsinks.  
 Voltage: 46.8v.  
 Amperage: 5000mAh.  
 Weight: 5.600Kg (11.23lb) +/-0.5Kg (1.1lb)  
 Dimensions : H : 92mm (3.62") I : 382mm (15.03") L : 170mm (6.70") +/-5mm (0.2")



- **BATfan NEO 2 Battery 45 minutes**

Reference: 2009255

Type: 38 VH A HR-AUE-4, NIMH (nickel-metal hydride).  
 Voltage: 46.8v.  
 Amperage: 9800mAh.  
 Weight: 8.500Kg (17.64lb) +/-0.5Kg (1.1lb).  
 Dimensions : H : 95mm (3.74") I : 382mm (15.03") L : 170mm (6.70") +/- 5mm. (0.2")

## 5 PRESENTATION

**BATfan 2 NEO** is equipped with a lateral control console and benefits from **Easy Pow'Air** technology and a **NEO grille**.

> Description:

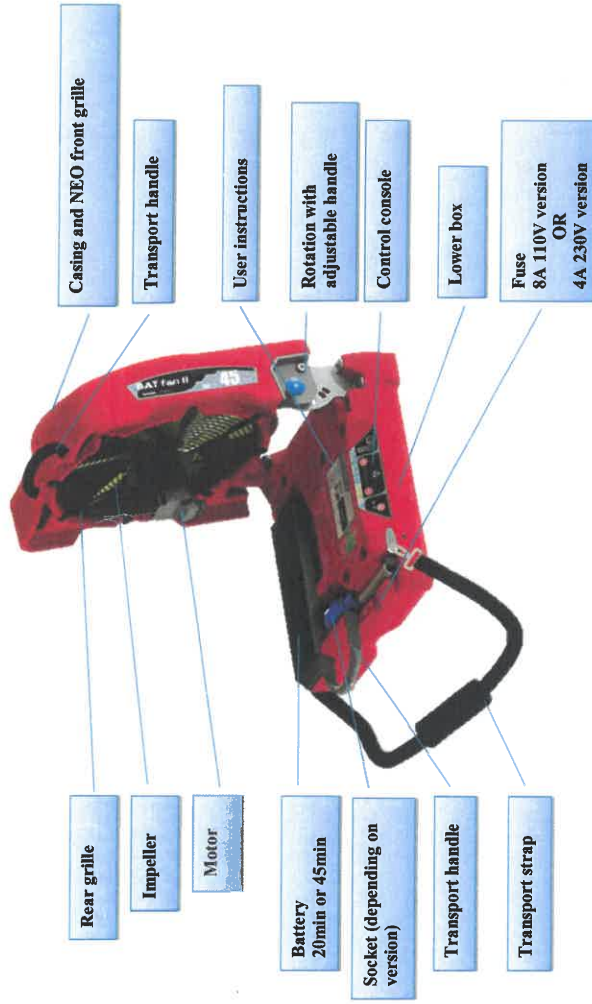

Available options:

Designation	Reference
"Rehab" mister	160.20.164
H <sub>2</sub> O-expansion foam adapter - BSP F 3/4" input.	160.20.105
5m blowing and suction spiral sheath	163.20.025
164ft (50m) / 3G x 2.5mm <sup>2</sup> extension cable in a bag with lockable European sockets for 230V version.	160.00.016

- ⇒ Connect the plug to the AC power supply. (cf4.P7). The device automatically starts to charge. LED status (cf9.P14). If there is a problem, refer to the alarms table (P15)



**NB:** If you are charging will only start once the battery temperature falls below 104°F (40°C+).

### 5/ Fuses:

⚠ Never remove the fuses when the device is connected or operating. Leader will not be held liable for any damage due to inappropriate, incorrect or abnormal handling.

- A glass fuse is provided for surge protection. To change the fuse, unscrew the fuse holder cap.

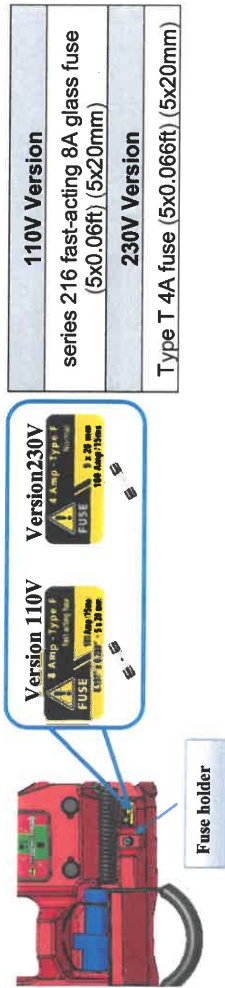

- A second fuse is provided for battery protection. To change the fuse, remove the Batfan 2 battery and unscrew the fuse holder located on the battery's wiring.

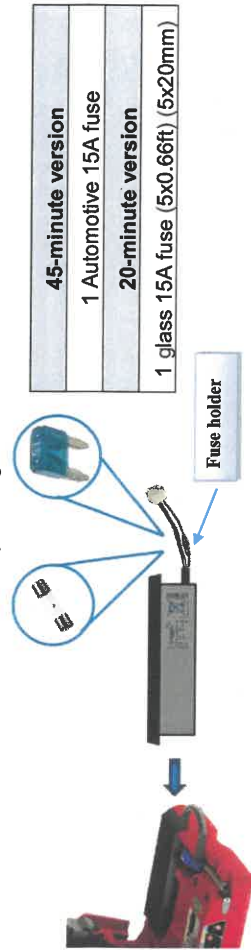

**Note:** the **BATfan 2 NEO** fan is a high-speed air drive fan. This portable fan is designed to remove smoke, volatile gas and other gas by blowing (or ventilation with excess pressure) in all types of facility where there is an outlet. It can also be used for suction of cold smoke. Due to their design, Batfan fans can be used at a distance from 2.95 to 19.69ft (0.6 à 6m) from an opening. **LEADER** recommends a minimum smoke removal opening the same size as the window.

### ➢ Description of control console:

