

THE TEMPEST BB-16 BATTERY BLOWER



POWERFUL, LIGHTWEIGHT, SELF-CONTAINED 50-Minute Run Time with Removable Battery



50-Minute Run Time

At Full Speed this powerful battery blower will run for 50 Minutes.



Removable Battery

Removable Lithium-Ion with 3 hour quick charge.



Only 51 Pounds w/Battery 42 Pounds without battery

Lightweight highly durable build makes it easy to carry and deploy on site using shoulder strap.



Wide Tilt Range

Tilt Range +65° to -90° with locking system (allows flat positioning to cover a manhole)



10.940 CFM

The BB-16 produces a very powerful airflow tested to AMCA standards.



Built In Battery Charger

When plugged in the battery is charging even while in use. (Charging occurs as long as the blower is not at 100% power)



Small Footprint

This Blower is half the size of a gas blower. BB-16: 22"L x 21"H x 11"D



LED Flow-Path Lighting

Powerful LED lights positioned low for visibility below the smoke.



WARRANTY

Blower: 3 Year Limited Warranty
Lithium-Ion Battery:
1 Years / 500 Charge Cycles

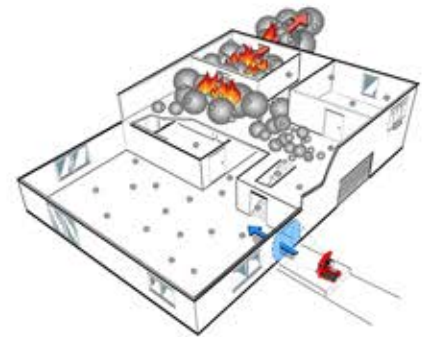

TEMPEST™

4708 N. Blythe Ave.
Fresno, CA. 93722
800.346.2143

response@tempest.us.com
www.tempest.us.com
Facebook.com/tempesttechnologycorp

TEMPEST BB-16 SPECIFICATIONS

| | | | |
|------------------------------|--|----------------------------------|--|
| Model | #910-1801 | BB16-110V (STANDARD) | ELECT. PPV POWER BLOWER, VARIABLE SPEED DRIVE, 16" IMPELLER BLDC MOTOR, WITH 1 BATTERY, 1 SHOULDER STRAP, NO EXTERNAL QUICK CHARGER |
| | #910-1802 | BB16-110V (STANDARD PLUS) | ELECT. PPV POWER BLOWER, VARIABLE SPEED DRIVE, 16" IMPELLER BLDC MOTOR, WITH 1 EXTERNAL QUICK CHARGER, 1 BATTERY, 1 SHOULDER STRAP |
| | #910-1803 | BB16-110V (DELUX) | ELECT. PPV POWER BLOWER, VARIABLE SPEED DRIVE, 16" IMPELLER BLDC MOTOR, WITH 1 EXTERNAL QUICK CHARGER, 2 BATTERIES, 1 SHOULDER STRAP |
| | #910-1811 | BB16-220V (STANDARD) | ELECT. PPV POWER BLOWER, VARIABLE SPEED DRIVE, 16" IMPELLER BLDC MOTOR, WITH 1 BATTERY, 1 SHOULDER STRAP, NO EXTERNAL QUICK CHARGER |
| | #910-1812 | BB16-220V (STANDARD PLUS) | ELECT. PPV POWER BLOWER, VARIABLE SPEED DRIVE, 16" IMPELLER BLDC MOTOR, WITH 1 EXTERNAL QUICK CHARGER, 1 BATTERY, 1 SHOULDER STRAP |
| | #910-1813 | BB16-220V (DELUX) | ELECT. PPV POWER BLOWER, VARIABLE SPEED DRIVE, 16" IMPELLER BLDC MOTOR, WITH 1 EXTERNAL QUICK CHARGER, 2 BATTERIES, 1 SHOULDER STRAP |
| Air Volume | 10,940 CFM | | |
| Weight | With Battery 51 lbs. Without Battery 42 lbs. | | |
| Dimensions L x H x D | 22"L x 21"H x 11"D | | |
| Propeller Diameter | 16" | | |
| Run Time | 50 Minutes at Full Speed | | |
| Operating Temperature | -4°F to +130°F | | |
| Motor | .8 HP / 600W Variable Speed Drive BLDC Totally Enclosed, Air Over IP66 | | |
| Battery | Removable 12.5 AH / 585 WH Li-Ion IP 65 | | |
| Charging Time | 100% Charge in 3 Hours with External Optional Charger | | |
| Ingress Protection | IP66 | | |
| Drop Test | Designed to resist a Drop Test of 1.5 M/5' | | |
| Noise level | 76.3 dB at 3m-10' | | |

OPTIONAL ACCESSORIES AVAILABLE

| | | | |
|--|---------------------|---|--|
| BB-16 Li-Ion Battery | #585-005 |  | 12.5 AH / 585 WH Li-Ion IP 65 Battery |
| BB-16 External Quick Charger | #585-035 |  | External Quick Charger for BB-16 Battery |
| Rehab Misting Ring | #725-200 |  | Easy to attach with velcro straps rehab misting collar with 3/4" NH coupling. |
| 5M - 16' Blowing / Suction Duct | #i63.20.025 |  | Deployed and connected in seconds, the ventilation spiral ducts are easy to install. |
| High Expansion Foam Adapter | #i60.20.105K |  | High expansion foam adapter with 1.5" BSP M premix inlet. Delivered with 35m - 115' of PE plastic Film |